

/SCHULRAUM LERNFÖRDERLICH GESTALTEN

VON LEHRRÄUMEN ZU LERNRÄUMEN

DR. MICHAEL KIRCH
GOETHE INSTITUT WARSCHAU
29.10.2018

/ RAUM

VON LEHRRÄUMEN ZU LERNRÄUMEN

DR. MICHAEL KIRCH
29.10.2018

RAUM

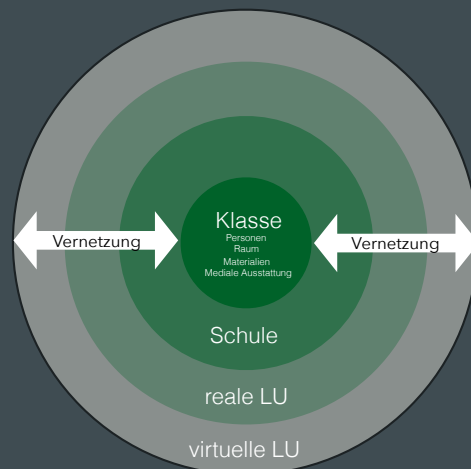

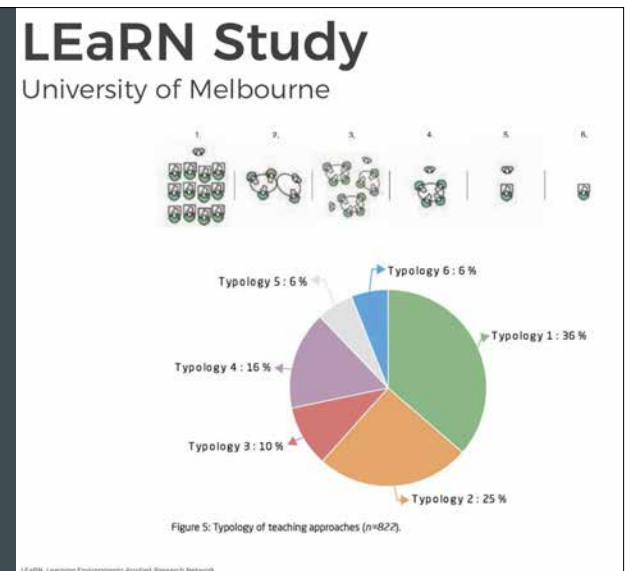
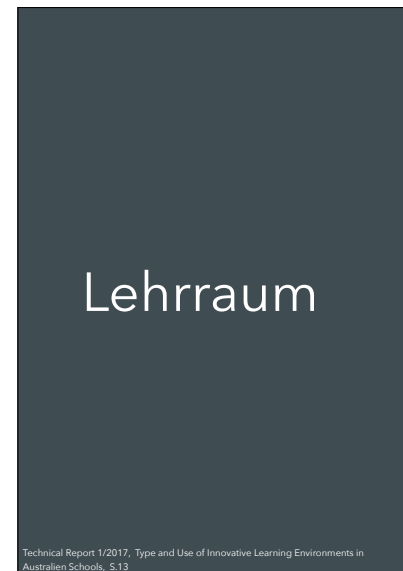
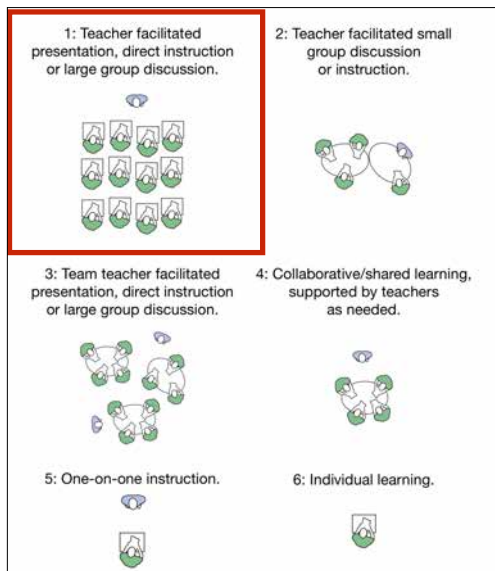
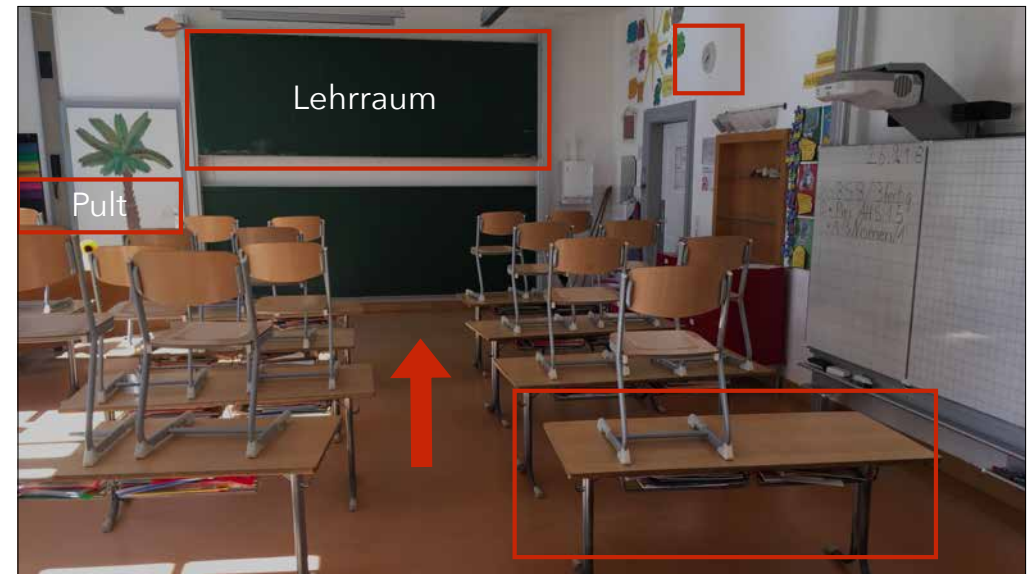
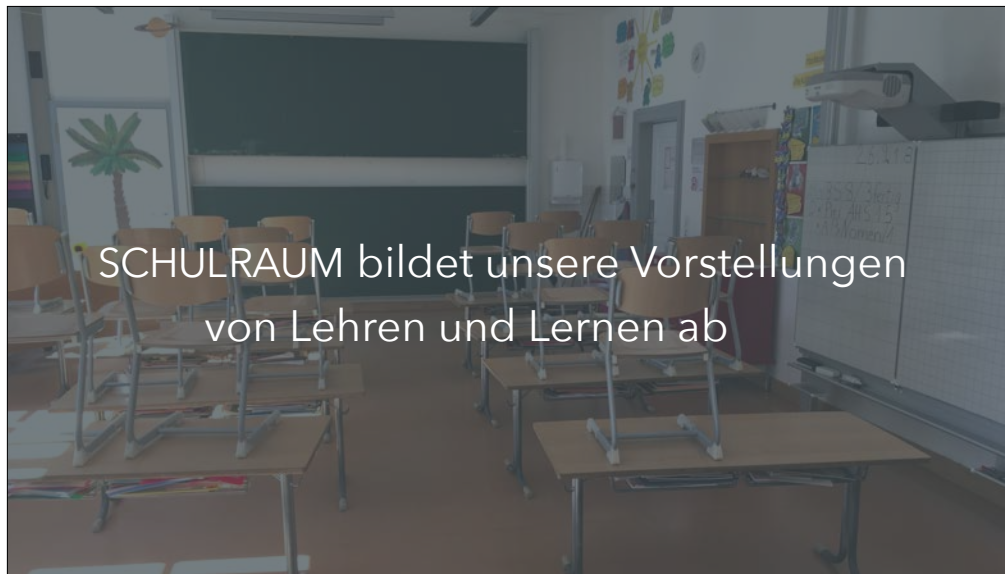

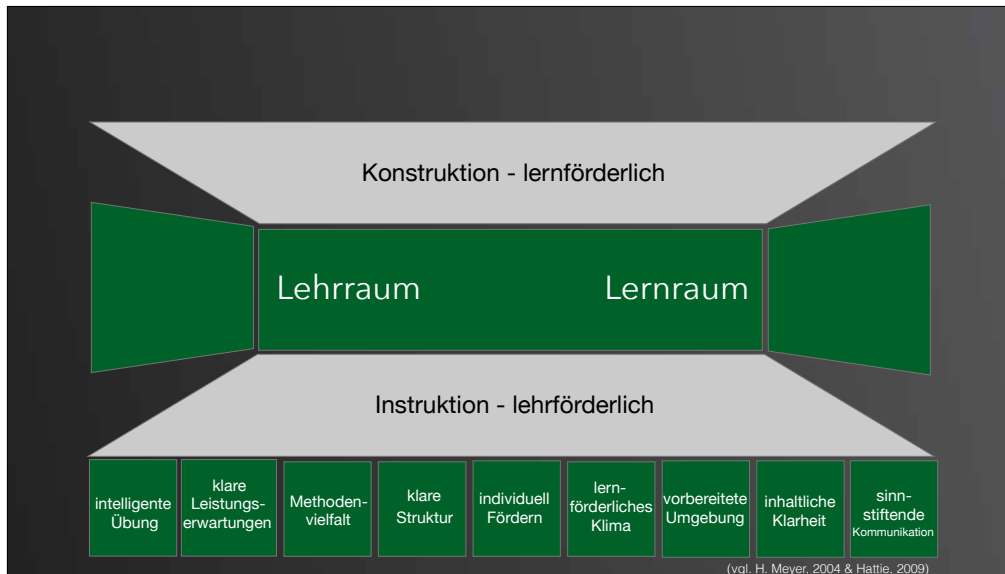

Lernraum ?

Lernen ist wie ...

Journey Enlightenment

Growth Enrichment

Construction Empowerment

Transformation

Lernen ist wie ...

(vgl. Julia Atkin, 2018)

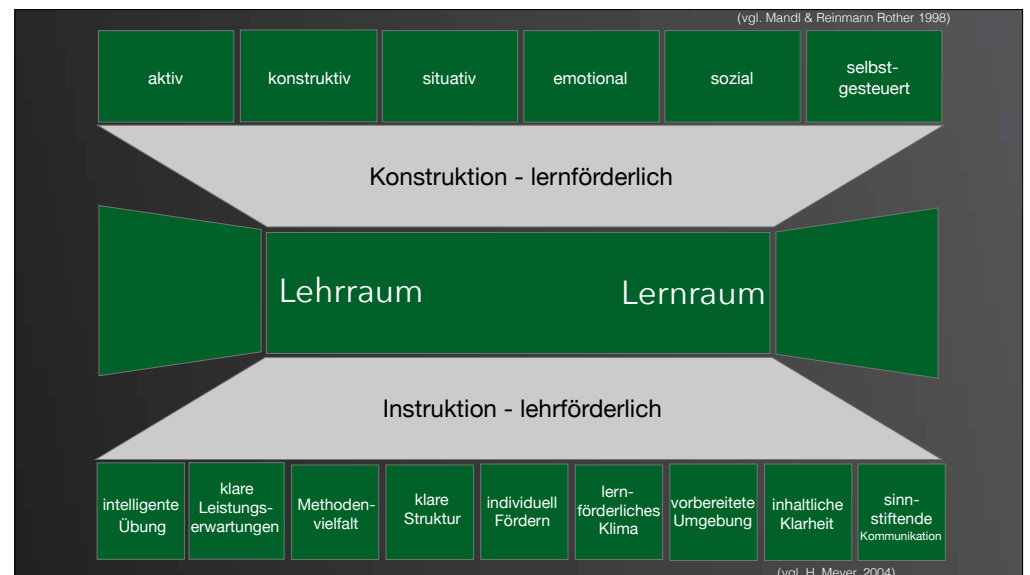

RAUM

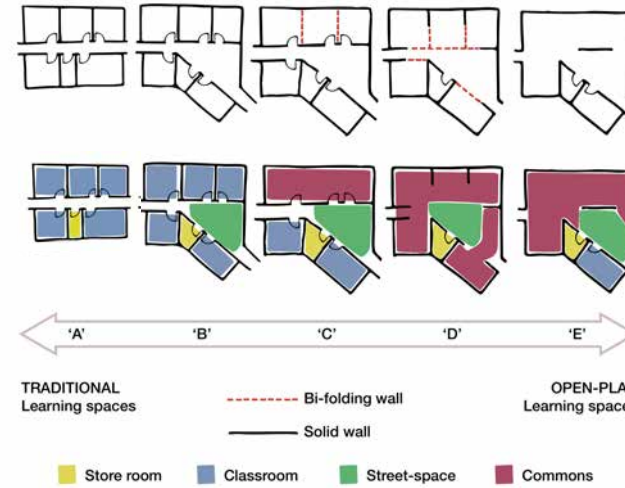
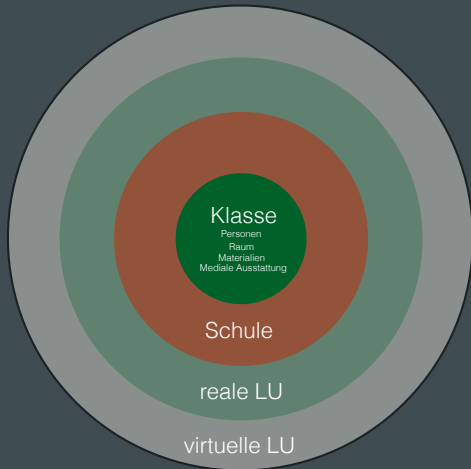

Figure 1: Dovey and Fisher's (2014) learning spaces types, as adapted in Imms, Cleveland, and Fisher (2016).

Technical Report 1/2017, Type and Use of Innovative Learning Environments in Australian Schools, S.12

Table 1: The five types of physical learning spaces

Of the five types of learning spaces illustrated below, please indicate the percentage of each type that is prevalent in your school. Please ensure that your answers total 100 percent.

- 1 Type A - Traditional closed classrooms entered by a corridor
- 2 Type B - Traditional classrooms with breakout space
- 3 Type C - Traditional classrooms with flexible walls and breakout space
- 4 Type D - Open plan with the ability for separate classrooms
- 5 Type E - Open plan with some adjoining spaces

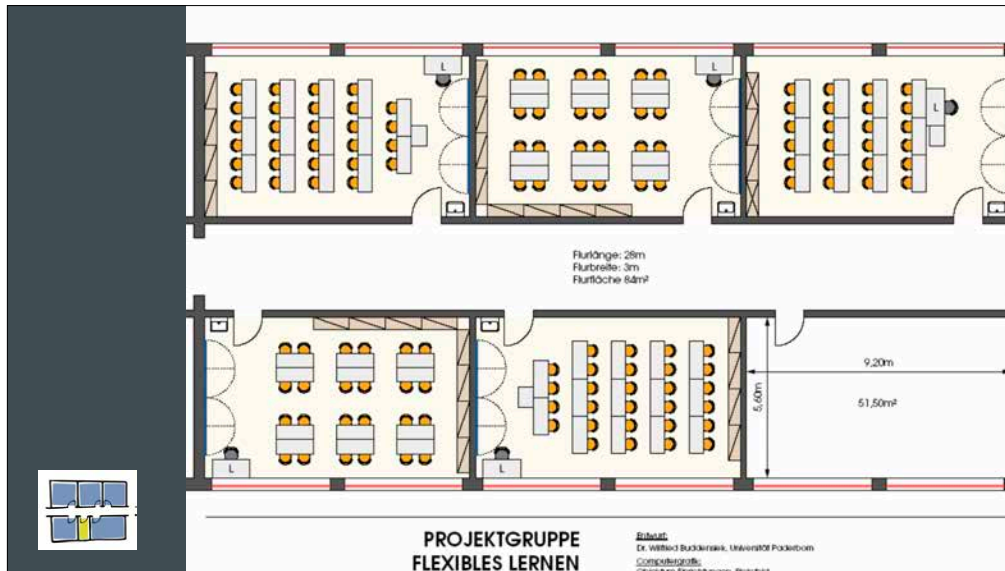

Figure 1: Dovey and Fisher's (2014) learning spaces types, as adapted in Imms, Cleveland, and Fisher (2016).

Technical Report 1/2017, Type and Use of Innovative Learning Environments in Australian Schools, S.12

Table 1: The five types of physical learning spaces

Of the five types of learning spaces illustrated below, please indicate the percentage of each type that is prevalent in your school. Please ensure that your answers total 100 percent.

- 1 Type A - Traditional closed classrooms entered by a corridor
- 2 Type B - Traditional classrooms with breakout space
- 3 Type C - Traditional classrooms with flexible walls and breakout space
- 4 Type D - Open plan with the ability for separate classrooms
- 5 Type E - Open plan with some adjoining spaces

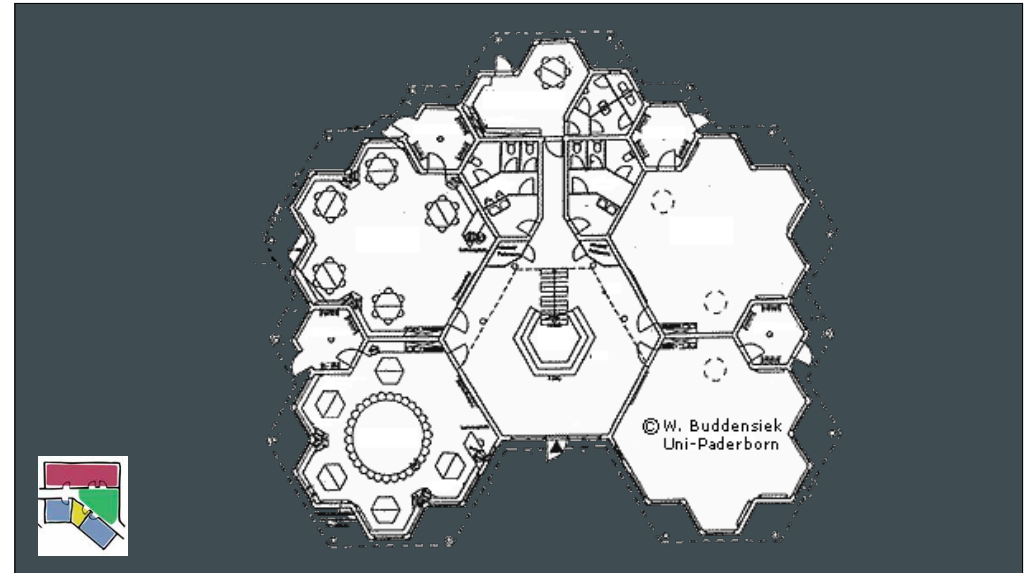
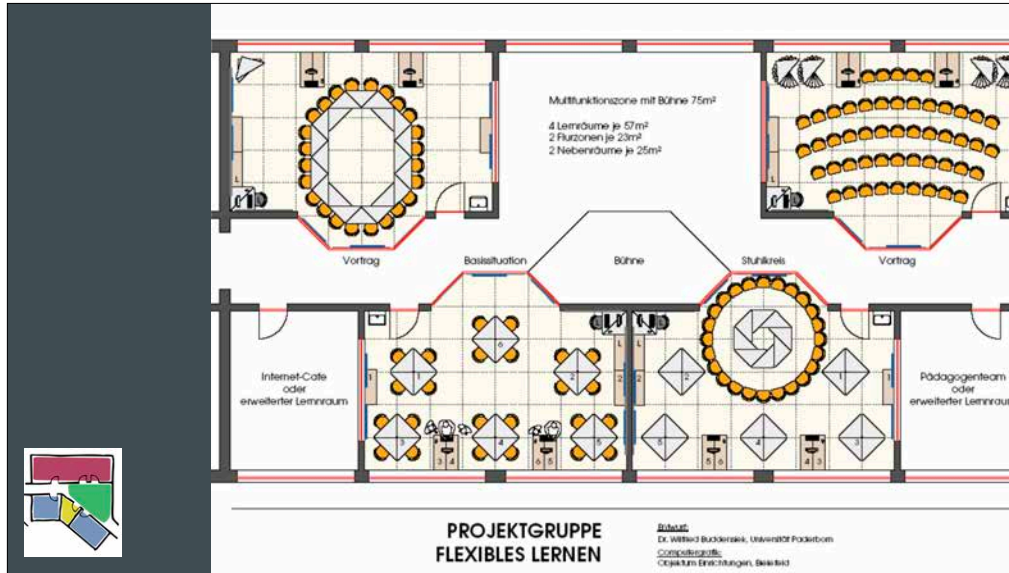

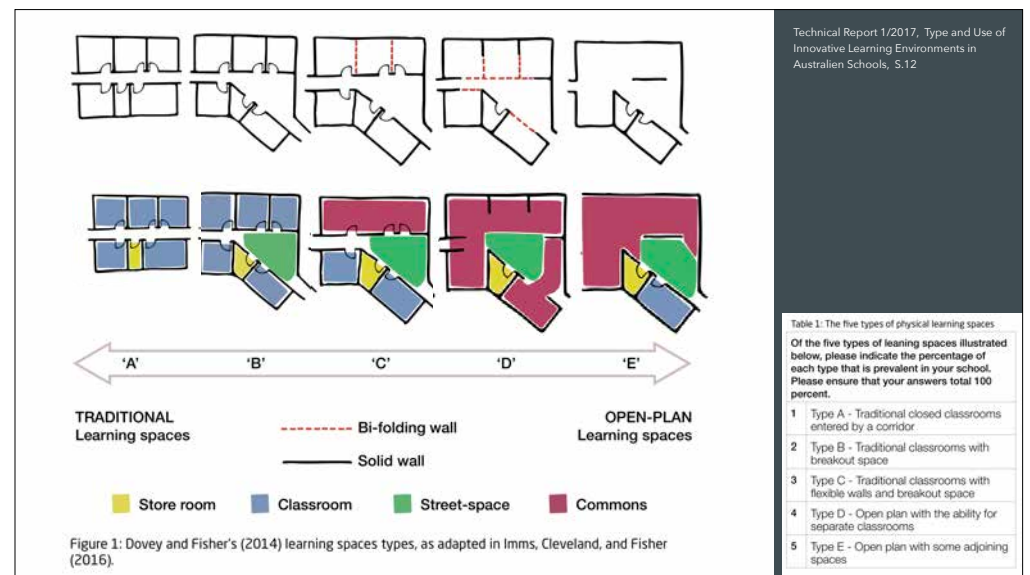



RAUM

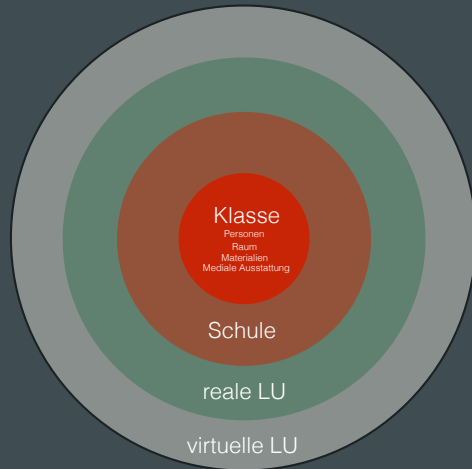

Campfire

Cave

Watering Hole

Mountaintop

Dr. David Thornburg









Hands On Motion Emotion

Rosan Bosch
vgl. B. Gerhardt, iba (2018) Kreative Lernwelten

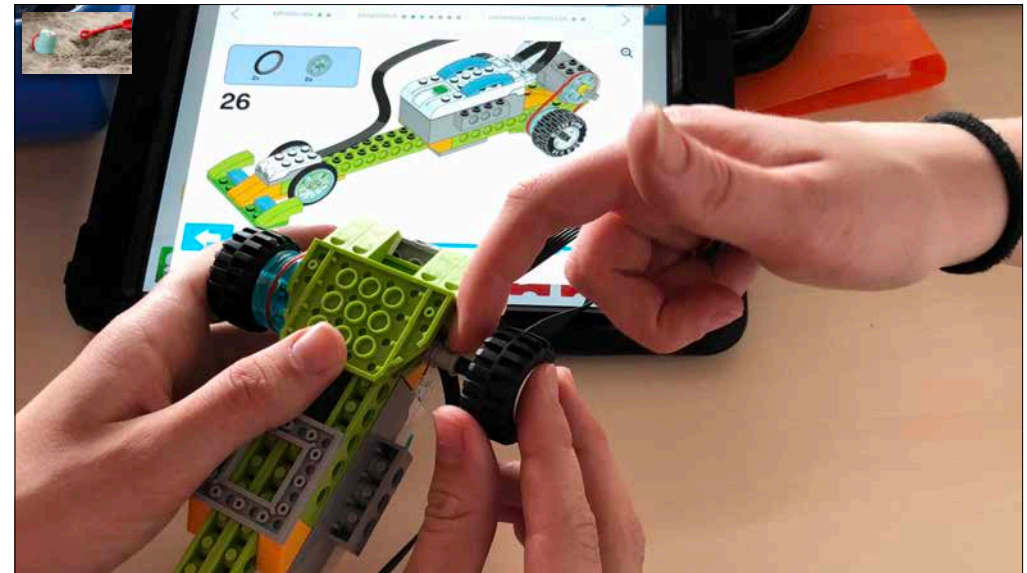
A dark grey rectangular area containing three white text elements: "Hands On", "Motion", and "Emotion" spaced out horizontally. Below them, in smaller white text, is "Rosan Bosch" and "vgl. B. Gerhardt, iba (2018) Kreative Lernwelten".

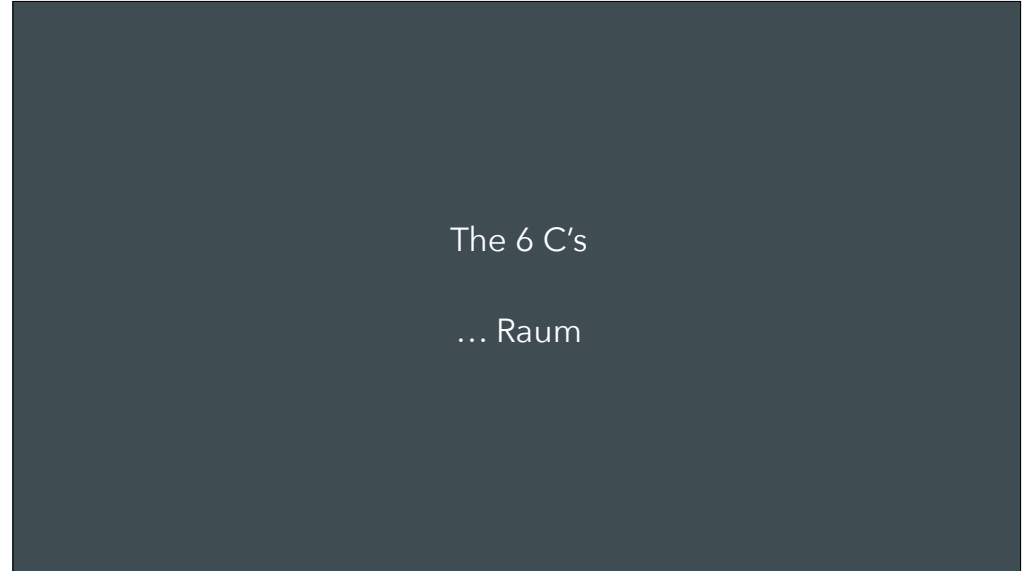

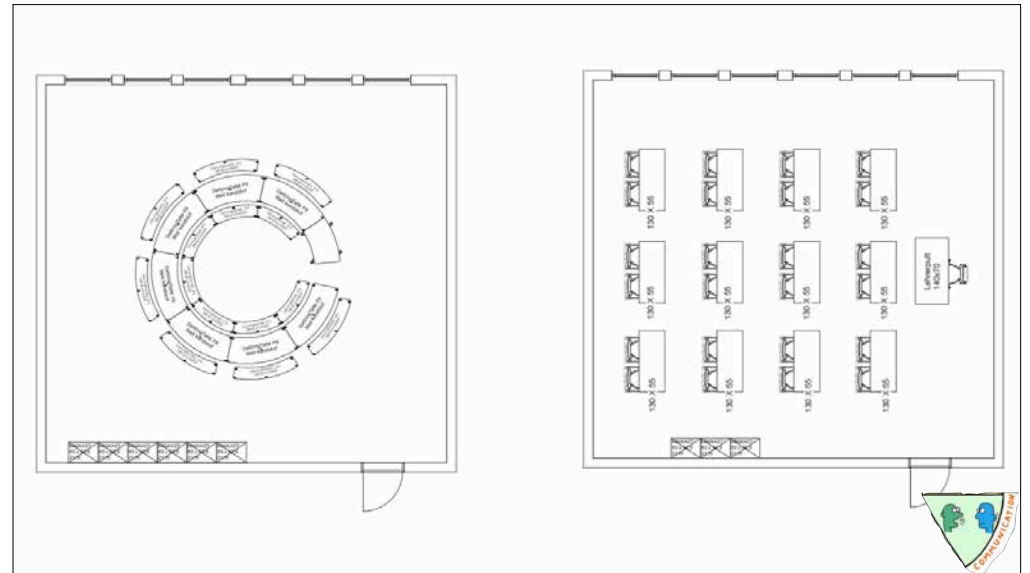

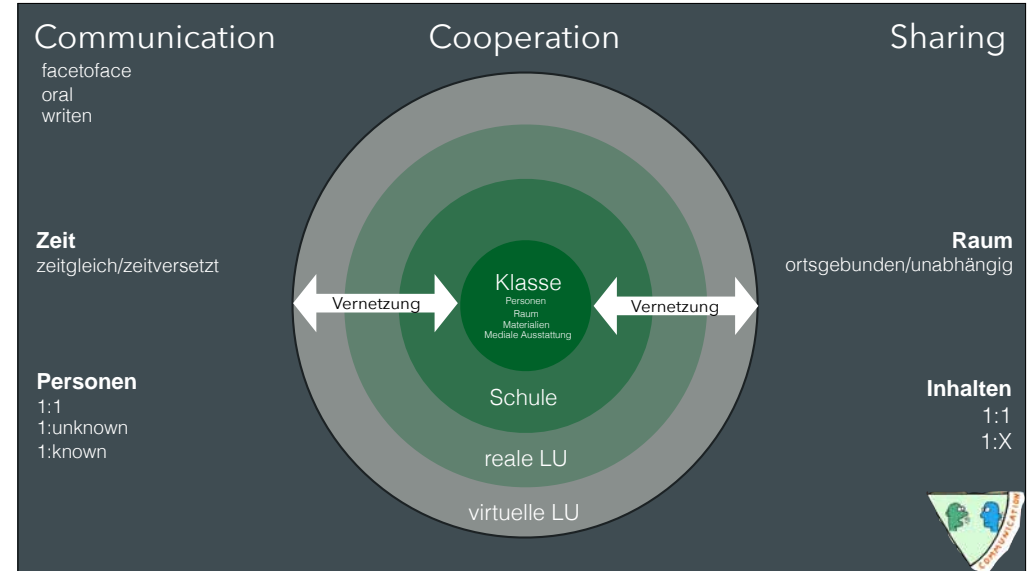

KOMMUNIKATIONS- UND KOOPERATIONSRÄUME

| KLASSE | KLASSE - WEB | WEB |
|---------------|---------------------------------|-------------------------------|
| zeitgleiche | zeitgleiche | zeitunabhängige zeitgleich |
| ortsgebundene | ortsgebundene ortsunabhängig | ortsunabhängige |
| face-to-face | face-to-face webbasiert | webbasiert |

KOOPERATIONS- UND KOMMUNIKATIONSPARTNER

| | | | |
|--------------------------|---------------------------|--------|---------|
| SCHÜLERINNEN UND SCHÜLER | LEHR-UND ERZIEHUNGSKRÄFTE | ELTERN | SCHULEN |
| EINRICHTUNGEN | EXPERTEN | | |

/ KOMMUNIKATIONS- UND KOOPERATIONSBEDINGUNGEN



1:1



CONNECTIVITY



CLOUD



CREATIVE COMMONS



OER

<https://creativecommons.org/licenses/?lang=de>



Dr. Michael Kirch
Leopoldstr. 13
Department of Pedagogy and Rehabilitation
Ludwig-Maximilians-University
80802 München

Tel.: 0049 89 2180 5106

/ mkirch@lmu.de

